



2-YEAR WARRANTY

Meet SAE and ECE-R13 Standards

IATF16949:2016

JIAXING TARGET AUTO PARTS CO.,LTD.

Add: No.183 Sihujing Rd., Qixing Industrial Park,
Nanhu District, Jiaxing, Zhejiang 314002

Phone: +86(0)573 8388 3208-802

Mobile: +86(0)139 6833 9795

E-mail: sherry@targetbrakes.com

www.targetbrakes.com



WhatsApp



Wechat



COMMITTED TO QUALITY...

Jiaxing Target Auto Parts Co., Ltd

Professional OEM/ODM Brake Chambers Manufacturer

IATF 16949:2016





C Company Profile



TARGET Brakes, established in 2005, is a leading manufacturer and distributor of brake chambers for global commercial vehicle needs. We strictly adhere to the IATF16949 quality system from research and development to production, ensuring that all brake chambers and components meet or exceed SAE and ECE-R13 standards.

Our top-of-the-line facilities, include zigzag servo feeders, automatic stamping lines, OTC robot welding lines, CNC spin forming machines, force output and stroke testers, high-pressure air leakage testers, as well as cycle testers etc. Advanced equipments like these enable us to produce high-quality brake chambers at a lower cost. Additionally, we have developed our own ERP system, which integrates all processes and optimizes management, thus helps us stay competitive on cost and lead time.

More importantly, our company's growth is energized by experts with over 30 years of air brake engineering experience. Our team also includes top mechanical engineers who graduated from elite universities, as well as energetic members of production, inspection and sales that incorporate innovative concepts into TARGET Brakes products and operations. Here in TARGET Brakes, you will get solid support for the continuous and powerful development of your career.

Intelligent Equipment



AUTOMATIC MACHINING LINE



AUTOMATIC STAMPING LINE



AUTOMATIC SURFACE TREATMENT LINE



HIGHLY AUTOMATIC DIE CASTING PRODUCTION LINE



R & D Design

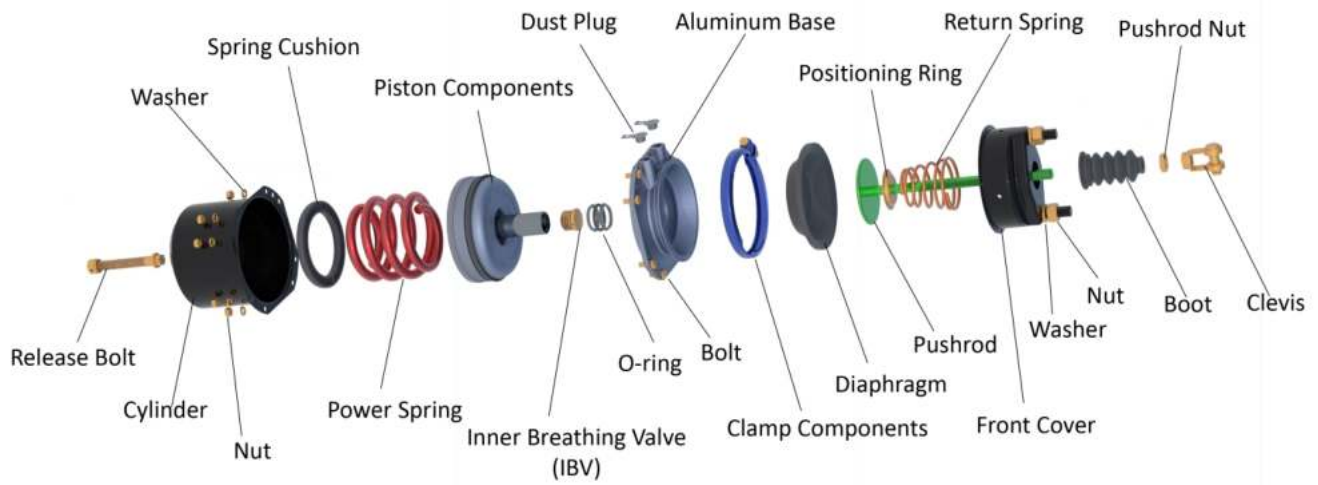

Good, Better, Best, Never Let It Rest.

Quality Control

TARGET Brakes, Safer World



COMPREHENSIVE PERFORMANCE TESTER



LOW&HIGH TEMPERATURE TESTER



COORDINATE MEASURING MACHINE



CYCLE TESTER



AIR LEAKAGE TESTER



INSPECTION



**Service Brake Chamber
S-Cam Brake**

S/N	Type	Distance between Bolts (mm)	Stroke (mm)	Air Ports	Pushrod Length (mm)	Reference No.	Main Application
1	T12	76.2	57	2x M16*1.5	186	K: BZ3261-II39908FA W: 423 103 9000	MERCEDES-BENZ DAF, MAN, SCANIA, VOLVO, RENAULT, KRONE,SCHMITZ CARGOBULL, BPW ...
2	T16	76.2	75	2x M16*1.5	186	K: BZ3370-II33198A W: 423 104 9000	
3	T20	120.7	75	2x M16*1.5	186	K: BX3416-II33458A W: 423 105 9000	
4	T24	120.7	75	2x M16*1.5	186	K: BX3534-II33441A W: 423 106 9000	
5	T30	120.7	75	2x M16*1.5	186	K: BX3604-II33444A W: 423 107 9000	



**Service Brake Chamber
Air Disc Brake**

S/N	Type	Distance between	Stroke (mm)	Air Ports	Pushrod Length (mm)	Reference No.	Main Application
6	T16	120.7	57	2x M16*1.5	15	K: BS3300-II14535 W: 423 104 7100	MERCEDES-BENZ DAF, SCANIA, VOLVO, KRONE, SCHMITZ CARGOBULL, BPW, SAF ...
7	T20	120.7	64	2x M16*1.5	15	K: BS3404-II31098 W: 423 505 0000	
8	T24	120.7	64	2x M16*1.5	15	K: BS3509-II30618 W: 423 506 0010	
9	T24	120.7	64	1x M22*1.5 with VOSS 232 +1x M12*1.5	15	K: BS3515-K003997N00	MERCEDES-BENZ
10	T24	120.7	64	2x M16*1.5	15	W: 423 506 1000, 423 506 1010, 423 506 1020, 423 506 1030, 423 506 1040, 423 506 1200, 423 506 1210, 423 506 1220, 423 506 1230, 423 506 1240	VOLVO, RENAULT



Service Brake Chamber Wedge Brake

S/N	Type	Mounting Tube Thread	Tube Length (Measured to c/l of air port) (mm)	Stroke(mm)	Air Ports	Reference No.	Main Application
11	T12	M48x2.0	152	50	1x M16*1.5	K: EF120BY	IVECO
12	T12	M48x2.0	187	50	1x M16*1.5	K: EF120FY	
13	T16	M48x2.0	152	53	1x M16*1.5	K: EF161AY	
14	T16	M48x2.0	187	53	1x M16*1.5	K: EF161FY	
15	T20	M48x2.0	180	53	1x M16*1.5	K: EF201BY	
16	T20	M48x2.0	230	53	1x M16*1.5	K: EF201LY	
17	T24	M48x2.0	180	53	1x M16*1.5	K: EF241BY	
18	T24	M48x2.0	245	53	1x M16*1.5	K: EF241LY	



S/N	Type	Mounting Dimension (mm)	Mounting Hole (mm)	Tube Length (Measured to c/l of air port) (mm)	Stroke(mm)	Air Ports	Reference No.	Main Application
19	T16	80x36	4xΦ10.5	207	55	1x Rc3/8"	W: 423 072 0700	HINO
20	T20	80x36	4xΦ10.5	207	55	1x Rc3/8"	W: 423 074 0800, 423 074 1020	
21	T24	80x36	4xΦ10.65	209	55	1x Rc3/8"	W: 423 076 0200	
22	T24	80x36	4xΦ10.5	209	55	1x Rc3/8"	W: 423 076 1000	



Double Diaphragm Spring Brake Chamber S-cam Brake

S/N	Type	Distance between Bolts (mm)	Stroke(mm)	Air Ports	Pushrod Length (to yoke pin centre) [mm]	Pushrod Length (mm)	Reference No.	Main Application
23	T20/24	120.7	64/64	2x M16*1.5	285	242	K: BX7401-K031736N00	TRAILER
24	T20/30L	120.7	75/75	2x M16*1.5	227	184	K: BX7408-K031733N00, BX7409-K031734N00 W: 925 370 3000	SCHMITZ CARGOBULL, KRONE, KÖGEL, BPW, SAF...
25	T20/30L	120.7	75/75	2x M16*1.5	250	207	K: BX7406-K031732N00	
26	T24/24	120.7	64/64	2x M16*1.5	280	237	K: BX7516-K031738N00	TRAILER
27	T24/30	120.7	64/64	2x M16*1.5	250	207	K: BX7514-K031748N00 W: 925 361 1000, 925 376 2000	DAF, RENAULT, SCANIA
28	T24/30L	120.7	75/75	2x M16*1.5	227	184	K: BX7525-K031740N00, BX7526-K040847N00, BX7547-K049117N00 W: 925 376 0000	SCHMITZ CARGOBULL, KÖGEL, DAF, IVECO, RENAULT, BPW, SAF...
29	T24/30L	120.7	75/75	2x M16*1.5	250	207	K: BX7523-K031739N00, BX7515-K037970N00 W: 925 376 1240, 925 371 3000	SCHMITZ CARGOBULL, KÖGEL, ,DAF, IVECO, RENAULT...
30	T30/30	120.7	64/64	2x M16*1.5	280	237	K: BX7611-K031744N00 W: 925 362 1000, 925 377 0020	DAF, RENAULT
31	T30/30L	120.7	75/75	2x M16*1.5	288	245	P: PRO0000100 W: 925 377 1000, 925 377 1100	VOLVO, SCANIA, DAF, SCHMITZ CARGOBULL, BPW, SAF...





Double Diaphragm Spring Brake Chamber Air Disc Brake

S/N	Type	Distance between Bolts (mm)	Stroke(mm)	Air Ports	Pushrod Length (mm)	Reference No.	Main Application
32	T16/24	120.7	57/57	2x M16*1.5	15	K: BS7309-K159939N00 W: 925 384 0100, 925 384 0010	DAF, SCANIA, VOLVO, SCHMITZ CARGOBULL, BPW, SAF...
33	T20/24	120.7	64/64	2x M16*1.5	15	K: BS7402-K159954N00 W: 925 380 1010	DAF, SCANIA, BPW, SAF...
34	T16/24 H pipe	120.7	57/57	2x M16*1.5 with H pipe extension	15	W: 925 384 0160 P: PRO7127150	BPW, SAF...
35	T20/24 H pipe	120.7	64/64	2x M16*1.5 with H pipe extension	15	W: 925 380 1040 P: PRO7127160	BPW, SAF...





Diaphragm Piston Spring Brake Chamber S-cam Brake

S/N	Type	Distance between Bolts (mm)	Stroke(mm)	Air Ports	Pushrod Length (to yoke pin centre) [mm]	Reference No.	Main Application
36	T24/24	120.7	57/57	2x M22*1.5 with M16*1.5 adapter	290	W: 925 491 1410, 925 491 1417, P: PRO 421 0020,	DAF, MAN, SCANIA, SCHMITZ CARGOBULL...
37	T24/24	120.7	64/64	2x M16*1.5	299	W: 925 431 0930, 925 431 1400, 925 491 1030, 925 491 1070, P: PRO 431 0010, PRO 491 0010	VOLVO, RENAULT, SCANIA, DAF...
38	T24/30	120.7	57/57	2x M22*1.5	200	W: 925 421 4510, 925 421 4520, 925 421 4530 K: BX9553-K002609	MAN
39	T24/30	120.7	64/64	2x M16*1.5	88	W: 925 421 0260, 925 421 0270, 925 421 0280, P: PRO 421 0040	VOLVO
40	T27/24	120.7	64/64	2x M16*1.5	297	W: 925 499 0030, 925 499 0280, P: PRO 499 0010	VOLVO, RENAULT, MERITOR
41	T27/30	120.7	64/64	2x M22*1.5 with M16*1.5 adapter	350	W: 925 499 0010, 925 429 9000, 925 429 9010, K: BZ9559-II37098	DAF, RENAULT, MAN
42	T30/24	120.7	64/64	2x M16*1.5	285	W: 925 422 6030 P: PRO 432 0010	BENZ, SCANIA
43	T30/24	120.7	64/64	2x Rc3/8"	90	W: 925 492 0400 P: PRO 492 0020	HINO, UD TRUCKS
44	T30/30	120.7	64/64	2x M22*1.5 with M16*1.5 adapter	302	W: 925 492 1020, P: PRO 713 1000	SCANIA, SCHMITZ CARGOBULL...

All VOSS232 and M16*1.5 adapters are made of brass.



**Diaphragm Piston Spring Brake Chamber
Air Disc Brake**

S/N	Type	Cylinder Material	Cylinder Finish	Stroke(mm)	Air Ports	Reference No.	Main Application
45	T12/24	Steel	E-coating	57/57	2x M22*1.5 with VOSS 232	W: 925 486 0100, 925 486 0110	MERCEDES-BENZ, DAF, MAN
46	T14/16	Steel	E-coating	57/57	2x M22*1.5	W: 925 426 2000, 925 426 2010	MAN
47	T14/16	Aluminum	Anodized	57/57	2x M22*1.5	K: BS9295-K007643, BS9296-K007642	
48	T16/16	Steel	E-coating	57/57	2x M16*1.5	W: 925 464 4500, 925 464 4510, 925 464 4520, 925 464 4527 P: PRO 713 0020	MERCEDES-BENZ, DAF,SCANIA, SCHMITZ CARGOBULL, KRONE, KÖGEL...
49	T16/16	Aluminum	Anodized	57/57	2x M16*1.5	K: BS9397-II31227	
50	T16/24	Steel	E-coating	57/57	2x M16*1.5	W: 925 464 5000, 925 464 5010, 925 464 5050	DAF,KRONE, SCANIA, MERCEDES-BENZ
51	T16/24	Aluminum	Anodized	57/57	2x M16*1.5	K: BS9304-II30619	
52	T16/24	Steel	E-coating	57/57	2x M22*1.5 with VOSS 232	W: 925 484 0200, 925 484 0210	MERCEDES-BENZ
53	T16/24	Aluminum	Anodized	57/57	2x M22*1.5 with VOSS 232	K: BS9305-K002855N00, BS9306-K002854N00	
54	T16/24 HFL3	Aluminum	Anodized	64/64	2x M22*1.5 with VOSS 232	K: BS8330-K004876N00, BS8331-K004877N00	MERCEDES-BENZ





55	T20/24	Steel	E-coating	64/64	2x M22*1.5 with VOSS 232	W: 925 480 0100, 925 480 0110, 925 480 0120, 925 480 0130	MERCEDES-BENZ
56	T20/24	Aluminum	Anodized	64/64	2x M22*1.5 with VOSS 232	K: BS9405-K004033N00, BS9406-K004034N00, BS9409-K004035N00, BS9410-K004036N00	MERCEDES-BENZ
57	T20/24 HFL1	Aluminum	Anodized	64/64	2x M22*1.5	K: BS8413-K007668N00, BS8414-K007669N00	MAN
58	T20/24 HFL3	Steel	E-coating	64/64	2x M22*1.5 with VOSS 232	W: 925 480 1200, 925 480 1210, 925 480 0020, 925 480 0030, 925 480 0040, 925 480 0050	MERCEDES-BENZ
59	T20/24 HFL3	Aluminum	Anodized	64/64	2x M22*1.5 with VOSS 232	K: BS8402-K004044000, BS8403-K004045000, BS9437-K004042N00, BS9438-K004043N00, BS9411-K002861N00, BS9412-K002860N00	
61	T20/27 Crimped	Steel	Zinc-Nickel Alloy	64/64	2x M16*1.5	K: BT5800-K009970N00, BT5801-K009971N00	IVECO, MAGIRUS
62	T22/24	Aluminum	Anodized	64/64	2x M16*1.5	K: BS8460-K007138N00, BS8461-K007139N00	DAF
63	T24/14	Aluminum	Anodized	64/45	2x M22*1.5 with M16*1.5 adapter	K: BS9510-K018094N00, BS9531-K018095N00	SCANIA
64	T24/14	Aluminum	Anodized	64/45	2x M22*1.5 with VOSS 232	K: BS8592-K097288N00	MERCEDES-BENZ
65	T24/14	Aluminum	Anodized	64/45	2x M16*1.5	K: BS8553-K016857N00, BS8554-K016858N00	MAN



66	T24/16	Steel	E-coating	64/45	2x M16*1.5	W: 925 481 2300, 925 481 2310, 925 481 2320, 925 461 2900	SCANIA
67	T24/24	Steel	E-coating	57/57	2x M22*1.5 with VOSS 232	W: 925 481 0000, 925 481 0010	MERCEDES-BENZ
68	T24/24	Steel	E-coating	64/64	2x M22*1.5 with VOSS 232	W: 925 481 0120, 925 481 0130, 925 481 0100, 925 481 0110, 925 481 0140, 925 481 0150,	MERCEDES-BENZ
69	T24/24	Aluminum	Anodized	64/64	2x M22*1.5 with VOSS 232	K: BS9504-II32609000, BS9505-II32697000	
70	T24/24	Steel	E-coating	64/64	2x M16*1.5	W: 925 481 0300, 925 481 0310, 925 481 0320, 925 481 0330, 925 481 0340, 925 481 0400, 925 481 0500, 925 481 0510, 925 481 0060	VOLVO, RENAULT
71	T24/24 HFL3	Steel	E-coating	64/64	2x M22*1.5 with VOSS 232	W: 925 481 0200, 925 481 0210	MERCEDES-BENZ
72	T24/24 HFL3	Aluminum	Anodized	64/64	2x M22*1.5 with VOSS 232	K: BS9509-K004053000, BS9502-K004052N00	
73	T24/30	Steel	E-coating	64/64	2x M16*1.5	W: 925 481 0700, 925 481 0710	VOLVO, DAF
74	T24/30	Steel	E-coating	64/64	2x M16*1.5	W: 925 481 1200, 925 481 1210, 925 481 1220, 925 481 1230, 925 481 1260, 925 481 1270, 925 481 1280	VOLVO, RENAULT
75	T24/30	Steel	E-coating	64/64	2x M16*1.5	W: 925 481 3130	
76	T24/30	Aluminum	Anodized	64/64	2x M16*1.5	K: BS6526-K153999N00 BS6560-K210056N00 BS8500-K017119N00	SCANIA, DAF

All VOSS232 and M16*1.5 adapters are made of brass.



Diaphragm Piston Spring Brake Chamber Wedge Brake

S/N	Type	Mounting Tube Thread	Tube Length (Measured to c/l of air port) (mm)	Stroke(mm)	Air Ports	Reference No.	Main Application
77	T16/24	M48x2.0	190	53/53	2x M16*1.5	K: BY9328-K014032	IVECO
78	T16/24 HF	M48x2.0	190	53/53	2x M16*1.5	K: BY9346-K100421N00 BY9347-K100422N00	IVECO
79	T18/24HF	M48x2.0	190	53/53	2x M16*1.5	K: BY9351-II16159	IVECO
80	T20/24HF	M48x2.0	190	53/53	2x M16*1.5	K: BY9401-II16160	IVECO
81	T24/24 HF	M48x2.0	190	53/53	2x M16*1.5	K: BY9501-II17756	IVECO



S/N	Type	Mounting Dimension (mm)	Mounting Hole (mm)	Tube Length (Measured to c/l of air port) (mm)	Stroke(mm)	Air Ports	Reference No.	Main Application
82	T20/24	80x36	4xΦ10.65	211	55/55	2x Rc3/8"	W: 425 450 0800, 425 450 0810	HINO
83	T22/24	80x36	4xΦ10.65	211	57/57	2x Rc3/8"	W: 425 458 0500, 425 458 0510, 425 458 0540, 425 458 0550, 425 451 0500, 425 451 0510,	UD TRUCKS
84	T24/24	80x36	4xΦ10.5	211	57/57	2x Rc3/8"	W: 425 451 0000, 425 451 0010	HINO

Special Chamber

S/N	Type	Distance between Bolts (mm)	Stroke(mm)	Air Ports	Reference No.	Application
85	ZM440-D	120	64	2x1/4NPT	ZM440-D	HINO



S/N	Type	Distance between Bolts (mm)	Stroke(mm)	AirPorts	Reference No.	Application
86	T36	120.7	90	2xM22*1.5	BPW: 05.444.10.37.0	BPW AXLE LIFT



S/N	Type	Distance between Bolts (mm)	Stroke(mm)	AirPorts	Reference No.	Application
87	T30/30	120.7	64/64	2xRc3/8"	TR3030TJMHO Nabtesco: B3276-4016	TOHO



Air Hydraulic Actuator

S/N	Type	Distance between Bolts (mm)	Air Specification	Air Ports	Piston Rod Diameter (mm)	Piston Rod Port	Stroke(mm)
88	T16/20	76.2	16	2x M16*1.5	20	G 3/8-19	75
89	T16/25	76.2	16	2x M16*1.5	25	G 3/8-19	75
90	T20/25	120.7	20	2x M16*1.5	25	G 3/8-19	75
91	T20/30	120.7	20	2x M16*1.5	30	G 3/8-19	75
92	T24/25	120.7	24	2x M16*1.5	25	G 3/8-19	75
93	T24/30	120.7	24	2x M16*1.5	30	G 3/8-19	75
94	T24/35	120.7	24	2x M16*1.5	35	G 3/8-19	75
95	T30/25	120.7	30	2x M16*1.5	25	G 3/8-19	75
96	T30/30	120.7	30	2x M16*1.5	30	G 3/8-19	75
97	T30/35	120.7	30	2x M16*1.5	35	G 3/8-19	75



Hydraulic Actuator



S/N	Type	Piston Rod Diameter	Piston Rod Length	Port thread	Stroke
98	RAM-YG25075	25	68	G3/8-19	75

S/N	Type	Piston Rod Diameter	Piston Rod Length	Port thread	Stroke
99	20RAM75N1-C1	20	145	G3/8-19	75
100	25RAM75N1-C1	25	140	G3/8-19	75
101	30RAM75N1-C1	30	125	G3/8-19	75
102	35RAM75N1-C1	35	125	G3/8-19	75
103	YG30110-C1	30	175	G3/8-19	110



S/N	Type	Piston Rod Diameter	Piston Rod Length	Port thread	Stroke
104	20RAM75N1-C2	20	145	G3/8-19	75
105	25RAM75N1-C2	25	140	G3/8-19	75
106	30RAM75N1-C2	30	125	G3/8-19	75
107	35RAM75N1-C2	35	125	G3/8-19	75

S/N	Type	Piston Rod Diameter	Piston Rod Length	Port thread	Stroke
108	20RAM75N1-C3	20	145	G3/8-19	75
109	25RAM75N1-C3	25	140	G3/8-19	75
110	30RAM75N1-C3	30	125	G3/8-19	75
111	35RAM75N1-C3	35	125	G3/8-19	75





S/N	Type	Piston Rod Diameter	Piston Rod Length	Port thread	Stroke
112	20RAM75N1-C4	20	145	G3/8-19	75
113	25RAM75N1-C4	25	140	G3/8-19	75
114	30RAM75N1-C4	30	125	G3/8-19	75
115	35RAM75N1-C4	35	125	G3/8-19	75

S/N	Type	Piston Rod Diameter	Piston Rod Length	Port thread	Stroke
116	20RAM75N1-C5	20	145	G3/8-19	75
117	25RAM75N1-C5	25	140	G3/8-19	75
118	30RAM75N1-C5	30	125	G3/8-19	75
119	35RAM75N1-C5	35	125	G3/8-19	75



S/N	Type	Piston Rod Diameter	Piston Rod Length	Port thread	Stroke
120	YG30110-C6	30	252	G3/8-19	110



R Replacement Parts





Service Worldwide

Our Mission: TARGET Brakes, Safer World!

Our Vision: To build a globally influential brake chamber industry cluster.

Our Value: Honesty, Respect, Openness, Innovation.

Our Positioning: Premium Quality Brake Chamber Manufacturer in China.